

1MORE
hear more

PISTON FIT BLUETOOTH

In-Ear Headphones w/ Microphone + Remote



Where Function Meets Form

1MORE's Piston Fit Bluetooth In-Ear Headphones build off its wired predecessor while sticking true to its award-winning design. Enjoy a lightweight and comfortable headphone experience with the latest technology at a disruptive price point.

PISTON FIT BLUETOOTH

In-Ear Headphones w/ Microphone + Remote

The Piston Fit Bluetooth Headphones feature Bluetooth 5 technology, a durable aluminum alloy chamber with a 10mm Titanium dynamic driver and magnetic clasp earpieces for a seamless user experience on the go.

- **FAST & STABLE-** An optimized Bluetooth® 5 chipset enables faster transmission and a more stable connection during daily activities like exercising, working, or traveling.
- **TITANIUM COMPOSITE DYNAMIC DRIVER-** A 10mm dynamic driver with a titanium composite diaphragm balances powerful bass and exquisite detail. It reproduces crystal clear sound in an ultra-compact design for enhanced efficiency.
- **PERFECTED ERGONOMICS-** Lightweight earbuds with 45° oblique-angled nozzles naturally lay in your ear canals for a comfortable, secure fit during extended use.
- **WATER & SWEAT RESISTANT-** IPX4 water resistance ensures long-lasting resilience under outdoor conditions and rigorous exercise.
- **MAGNETIC CLASPING EARPICES-** Magnetic rear earbud covers provide a necklace like shape for convenient storage around your neck when not in use.



CONTENTS

- Piston Fit Bluetooth In-Ear Headphones
- Micro-USB Charging Cable
- 3 Sets of Additional Ear Tips (XS / S / L)
- Manual
- Product Catalogue
- 1MORE Bear Sticker



FEATURES

- Durable aluminum alloy chamber
- 10mm titanium dynamic driver
- 8-hour battery life
- IPX4 water resistance
- Magnetic clasp earpieces
- Bluetooth® 5
- Lightweight/ergonomic design
- Inline controls + microphone

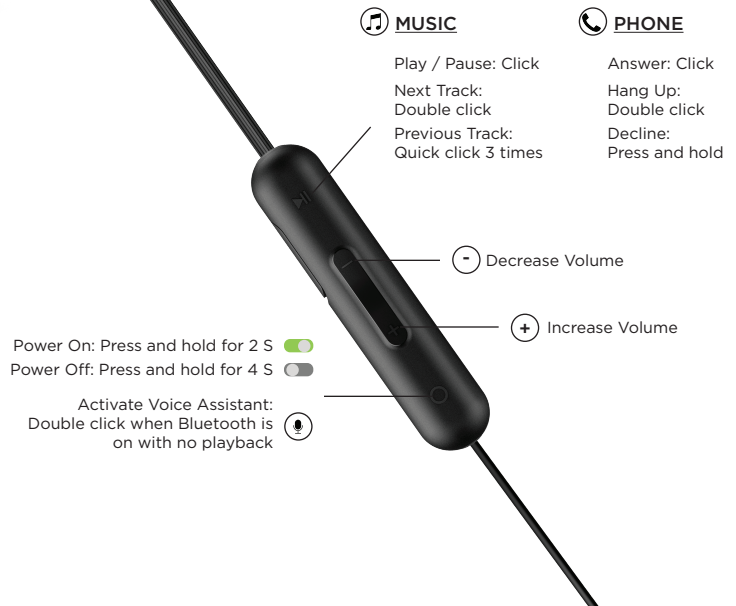

Model: E1028BT Weight: 18 g Charging Time: 60 minutes Talk Time: 8 hours Playback Time: 8 hours Standby Time: 200 hours (Bluetooth on with no operation)

Impedance: 32Ω Wireless Range: 10 m Input: 5V 1A Bluetooth: Bluetooth® 5 Bluetooth Protocol: HFP/A2DP/AVRCP

*The specifications are acquired from laboratory tested data